

DL-AR2 Technical Specifications

Universal HDMI Adapter Ring

Rev. 130814

The DL-AR2 Digital Adapter Keychain was developed to support the rising proliferation of mobile devices used in presentation systems. Most presentation infrastructures only support one or two input formats, usually HDMI® for Digital and VGA for Analog. This product permits the presenter easy access to the appropriate adapter for connection to the HDMI® infrastructure. Laptops, tablets, smart phones, digital cameras, and net books all have varying connections to display their content. This simple and effective ring of adapters permits the owner of the infrastructure to support mobile device content and keep the adapters secure and in place for the next presenter.

The full DL-AR2 unit includes the following adapters in the basic format: (1) DisplayPort male to HDMI female, (1) Mini-DisplayPort male to HDMI female, (1) Mini-HDMI “C” male to HDMI female, and (1) Micro-HDMI “D” to HDMI female. The adapters are molded with a very strong eyelet that attach to the aircraft-grade steel cable. The main clamp is ABS and it can connect to HDMI cables up to 11mm in diameter. Two sets of foam rubber inserts for differing cable sizes are included.

The security features of the ring are two staged. The clamp cannot be opened or installed without a Torx® T10 Pin driver. This security screw has the raised pin in the center of the star to prevent standard Torx® drivers from use. Inside the clamp is a second security feature, a steel ring with a 1.5mm hex set screw that locks the ends of the cables together. The unit is shipped with four Torx® Pin screws and nuts. Two are extra in case of loss. Liberty item T10PD is a simple tool kit of a T10 pin driver and a 1.5mm hex wrench. The T10PD is sold separately.



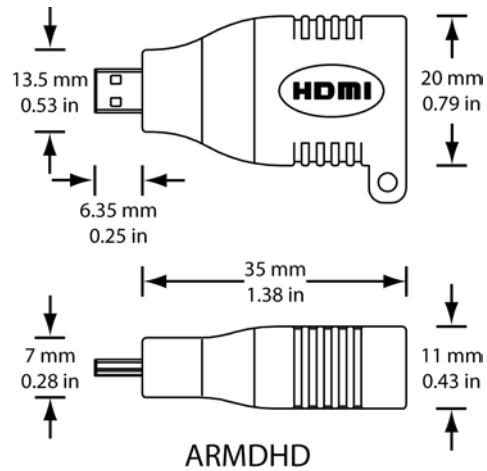
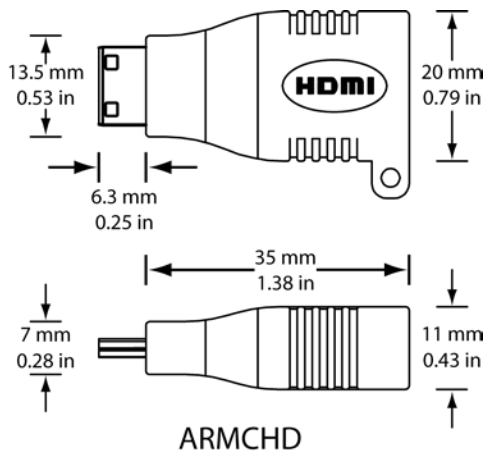
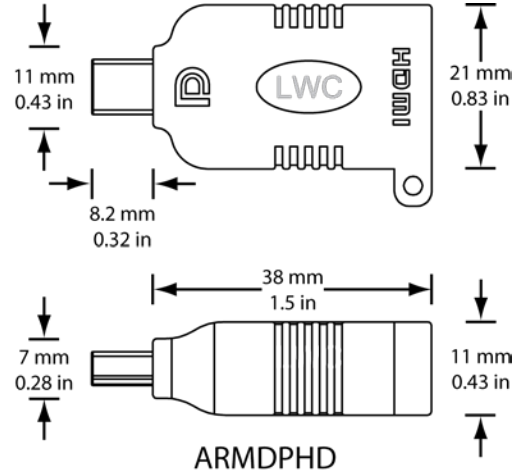
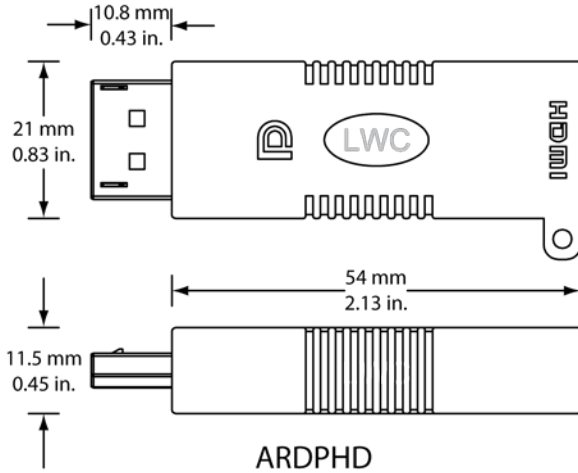

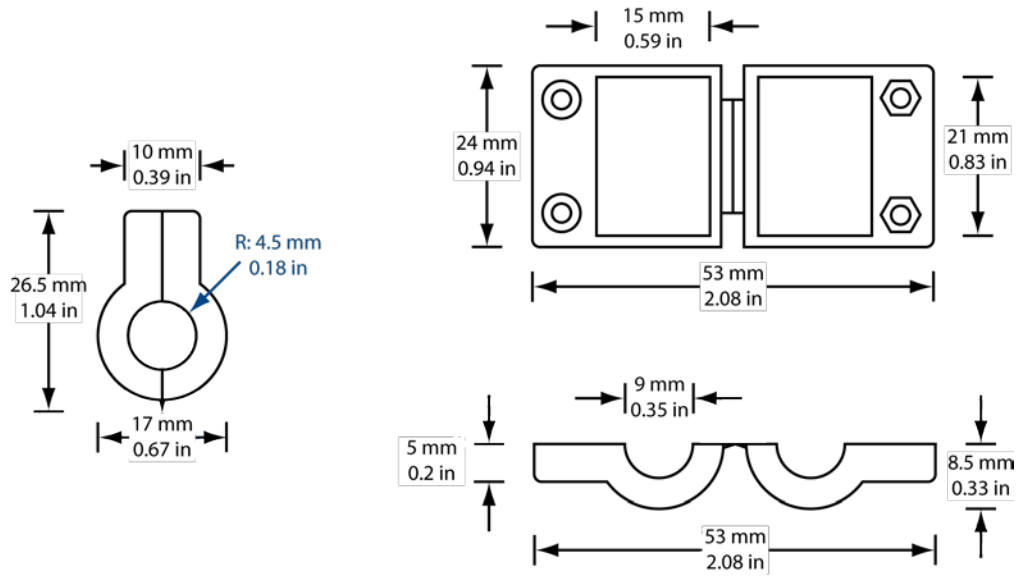

Cable Clamp

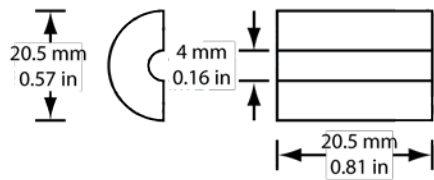

Small Diameter Insert

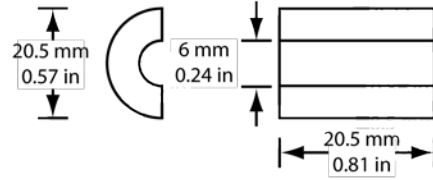

Mid Diameter Insert

Technical Specifications	
DisplayPort Adapter (ARDPHD)	
Input	Male full size DisplayPort connector
Output	Female HDMI type A receptacle
Compliance	DisplayPort 1.1 for 1.62 and 2.7 Gbps HDMI to 2.25 Gbps
Supported video resolutions	PC: Up to 1920x1200 HDTV: Up to 1080p
Mini DisplayPort Adapter (ARMDPHD)	
Input	Male mini DisplayPort connector
Output	Female HDMI type A receptacle
Compliance	DisplayPort 1.1 for 1.62 and 2.7 Gbps HDMI to 2.25 Gbps
Supported video resolutions	PC: Up to 1920x1200 HDTV: Up to 1080p
Mini HDMI Adapter (ARMCHD)	
Input	Male mini HDMI type C connector
Output	Female HDMI type A receptacle
Compliance	HDMI to 2.25 Gbps
Supported video resolutions	PC: Up to 1920x1200 HDTV: Up to 1080p
Micro HDMI Adapter (ARMDHD)	
Input	Male micro HDMI type D connector
Output	Female HDMI type A receptacle
Compliance	HDMI to 2.25 Gbps
Supported video resolutions	PC: Up to 1920x1200 HDTV: Up to 1080p
Cable and Clamp Assembly (DL-CL)	
Security Cable Material	Steel with black polyethylene sheath
Security Cable Length	450 mm (17.72 in)
Cable Clamp Dimensions (closed)	17 mm x 24 mm x 26.5 mm (0.67 in x 0.94 in x 1.04 in.)
Cable Clamp Inner Diameter	9 mm (0.35 in.)
Cable Clamp Material	Black ABS plastic
Mid Insert Diameter	6 mm (0.24 in.)
Small Insert Diameter	4 mm (0.16 in.)
Mid, Small Insert Material	Foam rubber
Other	
Warranty	2 years
Included Accessories	Four T-10 screws, Four M3 nuts, one retaining ring, one 1.5 mm hex retaining screw
Optional Toolkit	T10PD

DL-AR PATENT PENDING

UNIVERSAL HDMI ADAPTER RING STEP-BY-STEP INSTRUCTIONS

The complete assembly (DL-AR) comes with the 5 most popular display adapters used in presentations.

Adapters are also available separately so that you can create your own custom assembly! (HDMI CABLE SOLD SEPARATELY)

Note: You will need a Torx® T-10 Pin Driver and a 1.5mm Hex Key wrench to install and/or modify the DL-AR. Liberty tool kit T10PD contains both tools.

T-10 TORX® PIN DRIVER & 1.5MM HEX KEY WRENCH TOOL KIT **T10PD**

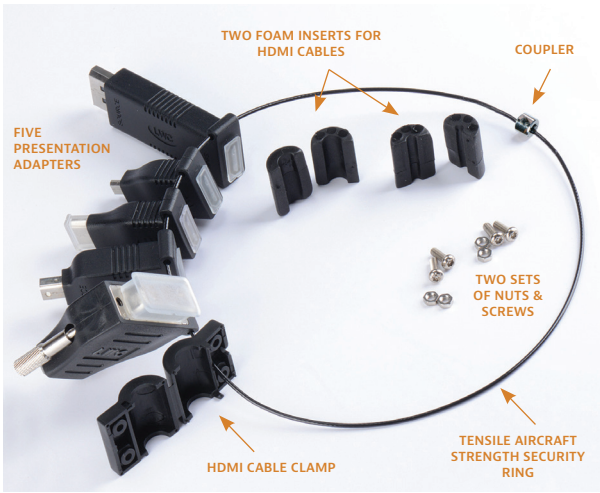

- 1)** If you are changing out any of the adapters, remove the coupler to open the security ring. Ensure the adapters you want are loaded on the security ring.

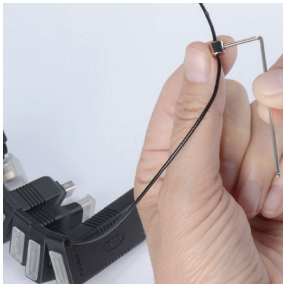

a. The security ring coupler has a 1.5mm hex set screw holding the two ends of the security cable locked together.

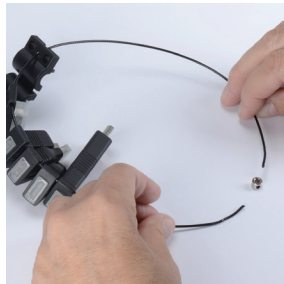

b. Loosen and back out the set screw to release the cable

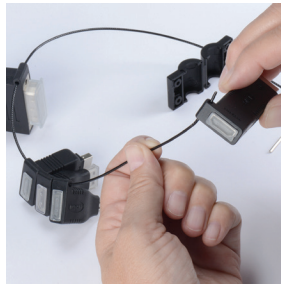

c. Replace, remove or add adapters as needed for your particular configuration

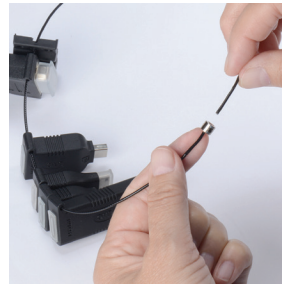

d. Feed the security ring back into the coupler. Ring ends can overlap.



e. Tighten set screw in coupler to secure your adapters and hold the ring together.

- 2)** Determine the diameter size of the HDMI cable you are using and place the correct foam inserts into the clamp. Several HDMI cable options are available at www.LibAV.com



Smallest Foam insert is for Micro cables 5mm or less in diameter

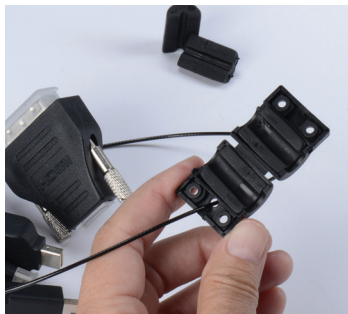

Large Foam insert is for most standard cables up to 9mm in diameter



No insert needed for really large HDMI cables above 9mm in diameter

For more info on the adapters and ordering info, go to www.LibAV.com or scan the code to go directly to the DL-AR web page.



SCAN QR CODE FOR MORE INFO



**LIBERTY
AV SOLUTIONS**

A SUBSIDIARY OF WESCO DISTRIBUTION, INC.

RUN WITH US

WWW.LIBAV.COM | 800.530.8998

UNIVERSAL HDMI ADAPTER RING

STEP-BY-STEP INSTRUCTIONS

(Continued From Other Side)

- 3)** Position the Cable Clamp onto the HDMI cable and close shut with your fingers. Position the Cable Clamp so you can feed the HDMI cable into the ends of the adapters comfortably without stressing the connection. Usually this is within 2-3 inches of the end of the HDMI connector molding.

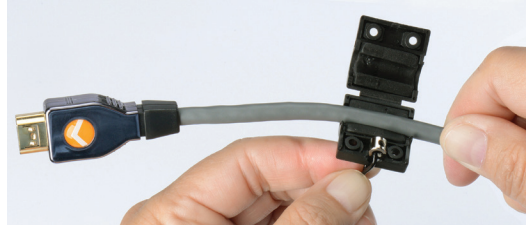

a. Position the coupler into the space between the two molded screw holes.

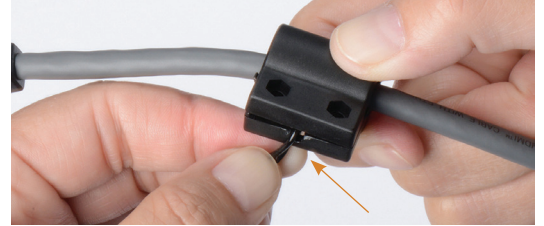

b) A helpful hint is to bend the two exiting wires straight down; this will enable correct positioning of the wire clamp into the cable clamp cavity.

- 4)** Secure the nuts and screws in the clamp to hold the HDMI cable to the security loop.

A looser insert can be used if you want your cable to slide, permitting it to be placed away when using HDMI only.

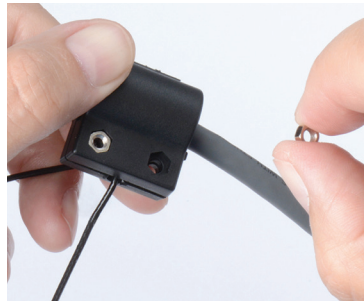

a. Place the nuts into the hex shaped holes.



b. Holding them in place with your finger, turn clamp over and then place the Torx® screws into the holes and tighten down with the Torx® Pin Driver.



The DL-AR assembly is now ready for use! The HDMI cable will stay connected to the security ring, and the variety of adapters for the next presenter will stay put and never get lost or go missing.



More adapters are in development!
Connect for all the latest updates.

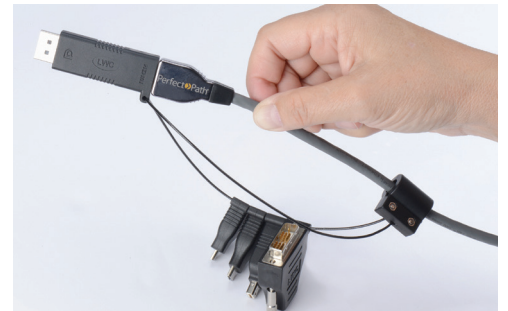
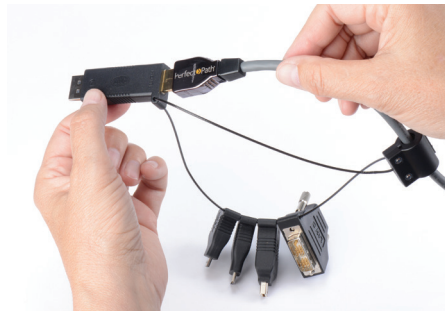

LIBERTY
AV SOLUTIONS

A SUBSIDIARY OF WESCO DISTRIBUTION, INC.

RUN WITH US

WWW.LIBAV.COM | 800.530.8998